



March 17, 2020

Mr. Alan Montanelli  
City of Stockton Municipal Utilities Department  
2500 Navy Dr.  
Stockton CA 95206

Dear Alan:

**Subject: Stockton Airport Business Center  
Storm Drain Basin Maintenance District**

On behalf of Siegfried Engineering, Inc., Engineer of Work for the subject maintenance district, I am submitting the following revised documents for the subject Maintenance District:

1. Proposed 2020-2021 Fiscal Year Budget.
2. Schedule of parcels and assessment amounts for the 2020-2021 budget and a list of the description of parcels by Assessor Parcel Number (A.P.N.).

Please refer to Amendment No. 10 to the Amended Assessment Diagram for Stockton Airport Business Park Assessment District, Project No. 84-1, Storm Basin Maintenance District.

The submittal appropriately addresses the requirements of Proposition 218 in that the parcels within the subject district receive one hundred percent (100%) of special benefits from the subject district and zero percent (0%) of general benefits.

Sincerely,  
**SIEGFRIED**

A handwritten signature in blue ink, appearing to read "Paul J. Schneider", is written over a horizontal line.

Paul J. Schneider, P.E.

PJS/jh

Enclosures

cc: Mr. Kevin Beltz, City of Stockton, Finance Department (w/ encl.)  
City of Stockton, City Clerk's Office (w/ encl.)



**Stockton**  
3428 Brookside Rd.  
Stockton, CA 95219  
t: 209.943.2021

**San Jose**  
111 N. Market St., #300  
San Jose, CA 95113  
t: 408.754.2021

**Sacramento**  
900 Howe Ave, #200  
Sacramento, CA 95825  
t: 916.520.2777

**Modesto**  
100 Sycamore Ave, #100  
Modesto, CA 95354  
t: 209.762.3580

**STOCKTON AIRPORT BUSINESS CENTER  
STORM DRAINAGE BASIN MAINTENANCE DISTRICT  
PROPOSED 2020-2021 FISCAL YEAR BUDGET**

---

|  |                    |
|--|--------------------|
| Inspection, Maintenance & Graffiti Control | \$14,850.00        |
| Fence Repairs                              | \$3,500.00         |
| <b>Operational Costs</b>                   | <b>\$18,350.00</b> |

|  |                    |
|--|--------------------|
| City of Stockton Publicity and Advertising Costs | \$85.00            |
| Maintenance District Attorney Fee                | \$1,514.00         |
| San Joaquin County Processing Fees               | \$133.00           |
| District Engineering Annual Engineer's Report    | \$2,119.00         |
| Professional Services                            | \$0.00             |
| City of Stockton Administrative Costs            | \$5,000.00         |
| <b>Total Administrative Costs</b>                | <b>\$8,851.00</b>  |
| Contingency                                      | \$2,370.00         |
| <b>Total 2020-2021 Budget</b>                    | <b>\$29,571.00</b> |

|   |                    |
|---|--------------------|
| <b>Less:</b> Contribution from Little John Creek<br>Landscape Maintenance District No. 94-1 | \$5,096.00         |
| <b>Less:</b> Contribution from Seabreeze<br>Landscape Maintenance District No. 96-2         | \$2,116.00         |
| Amount allocated from reserve   | \$9,167.00         |
| <b>Amount to be Assessed by<br/>Stockton Airport Business Center</b>                        | <b>\$13,192.00</b> |

---

|   |                           |
|---|---------------------------|
| <b>2020-2021 Maximum Assessment – Original District</b>                     | <b>\$18,678.23</b>        |
| <i>Calculated as each parcel's share by area of the original assessment</i> |                           |
| <b>2020-2021 Maximum Assessment – Parkside/Massie Annexation</b>            | <b><u>\$22,486.39</u></b> |
| <i>Calculated as a per acre assessment of \$75.33</i>                       |                           |
| <b>2020-2021 Maximum Total Assessment</b>                                   | <b>\$41,164.62</b>        |

The improvements being maintained by this district are a storm water retention basin and appurtenances which are site specific to the parcels being assessed. The improvements and appurtenances do not provide any benefit to any parcel or parcels outside the boundaries of the district that have not been charged their appropriate share which amount has been credited to the maintenance assessment prior to the determination of the final amount assessed to each parcel herein. In the opinion of the undersigned, the benefits received by the parcels assessed within the Stockton Airport Business Center, Storm Drain Maintenance District, from the Stockton Airport Business Center, Storm Basin Maintenance District, are identified as set forth by Proposition 218 as follows:

**Special Benefits - 100%**

**General Benefits - 0%**

Siegfried Engineering, Inc.  
Engineer of Work,

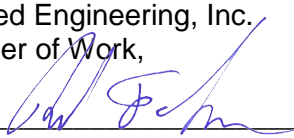

\_\_\_\_\_  
Paul J. Schneider, P.E.

\_\_\_\_\_  
3/17/2020

Date

Stockton Airport Business Center  
Storm Drainage Basin Maintenance District

**SCHEDULE OF PARCELS, ADJUSTED DRAINAGE AREAS, ANNEXED AREAS &  
ASSESSMENT AMOUNTS FOR 2020-2021 BUDGET**

March 17, 2020

| Maintenance Distr | Assessor's<br>Parcel Number<br>(if known) | Adjusted<br>Drainage Area<br>(Acres) | 2020-2021<br>Maximum<br>Assessment** | 2020-2021<br>Actual Assessment<br>Amount |
|-------------------|---|--------------------------------------|--------------------------------------|--|
| 1                 | 177-130-16                                | 5.476                                | \$243.37                             | \$100.50                                 |
| 2                 | 177-130-17                                | 5.664                                | \$251.73                             | \$103.95                                 |
| 3                 | 177-130-18                                | 4.965                                | \$220.66                             | \$91.13                                  |
| 5                 | 177-130-20                                | 8.752                                | \$388.97                             | \$160.63                                 |
| 6                 | 177-130-21                                | 2.535                                | \$112.67                             | \$46.53                                  |
| 11                | 177-130-26                                | 5.204                                | \$231.29                             | \$95.51                                  |
| 110               | 177-130-35                                | 6.548                                | \$291.02                             | \$120.18                                 |
| 111               | 177-130-36                                | 6.028                                | \$267.91                             | \$110.64                                 |
| 112               | 177-130-37                                | 8.868                                | \$394.13                             | \$162.76                                 |
| 207               | 177-130-38                                | 1.861                                | \$82.71                              | \$34.16                                  |
| 249               | 177-130-39                                | 21.079                               | \$936.83                             | \$386.88                                 |
| 96                | 177-310-18                                | 10.150                               | \$451.10                             | \$186.29                                 |
| 140               | 177-310-19                                | 4.370                                | \$194.22                             | \$80.21                                  |
| 141               | 177-310-20                                | 2.650                                | \$117.78                             | \$48.64                                  |
| 229               | 177-310-21                                | 1.310                                | \$58.22                              | \$24.04                                  |
| 142               | 177-310-22                                | 4.060                                | \$180.44                             | \$74.52                                  |
| 208               | 177-310-23                                | 29.070                               | \$1,291.98                           | \$533.54                                 |
| 254               | 177-310-26                                | 23.390                               | \$1,039.54                           | \$429.29                                 |
| 255               | 177-310-27                                | 1.090                                | \$48.44                              | \$20.01                                  |
| 247               | 177-510-01                                | 0.350                                | \$15.56                              | \$6.42                                   |
| 246               | 177-510-02                                | 0.300                                | \$13.33                              | \$5.51                                   |
| 245               | 177-510-03                                | 0.350                                | \$15.56                              | \$6.42                                   |
| 244               | 177-510-04                                | 0.340                                | \$15.11                              | \$6.24                                   |
| 243               | 177-510-05                                | 0.430                                | \$19.11                              | \$7.89                                   |
| 248               | 177-510-06                                | 2.150                                | \$95.55                              | \$39.46                                  |
| 30                | 179-240-07*                               | 1.411                                | \$62.71                              | \$25.90                                  |
| 31                | 179-240-08*                               | 1.294                                | \$57.51                              | \$23.75                                  |
| 32                | 179-240-09*                               | 2.408                                | \$107.02                             | \$44.20                                  |
| 33                | 179-240-10*                               | 2.505                                | \$111.33                             | \$45.98                                  |
| 83                | 179-240-11*                               | 2.652                                | \$117.87                             | \$48.67                                  |
| 34                | 179-240-16*                               | 4.502                                | \$200.09                             | \$82.63                                  |
| 35                | 179-240-17                                | 3.010                                | \$133.78                             | \$55.24                                  |
| 212               | 179-240-18                                | 2.310                                | \$102.67                             | \$42.40                                  |
| 213               | 179-240-19                                | 1.458                                | \$64.80                              | \$26.76                                  |
| 251               | 179-240-20                                | 2.310                                | \$102.67                             | \$42.40                                  |
| 82                | 179-270-04                                | 3.566                                | \$158.49                             | \$65.45                                  |
| 39                | 179-280-09                                | 1.824                                | \$81.07                              | \$33.48                                  |
| 40                | 179-280-10*                               | 2.887                                | \$128.31                             | \$52.99                                  |
| 41                | 179-280-11*                               | 2.363                                | \$105.02                             | \$43.37                                  |
| 42                | 179-280-13*                               | 3.150                                | \$140.00                             | \$57.81                                  |
| 45                | 179-280-19                                | 3.640                                | \$161.78                             | \$66.81                                  |
| 47                | 179-280-21                                | 3.510                                | \$156.00                             | \$64.42                                  |
| 48                | 179-280-22                                | 15.000                               | \$666.66                             | \$275.30                                 |
| 49                | 179-280-23                                | 9.444                                | \$419.73                             | \$173.33                                 |
| 97                | 179-280-30                                | 17.676                               | \$785.59                             | \$324.42                                 |
| 158               | 179-280-32                                | 9.910                                | \$440.44                             | \$181.88                                 |
| 215               | 179-280-34                                | 7.597                                | \$337.64                             | \$139.43                                 |
| 223               | 179-280-35                                | 2.085                                | \$92.67                              | \$38.27                                  |

Stockton Airport Business Center  
Storm Drainage Basin Maintenance District

**SCHEDULE OF PARCELS, ADJUSTED DRAINAGE AREAS, ANNEXED AREAS &  
ASSESSMENT AMOUNTS FOR 2020-2021 BUDGET**

March 17, 2020

| Maintenance District | Assessor's Parcel Number (if known) | Adjusted Drainage Area (Acres) | 2020-2021 Maximum Assessment** | 2020-2021 Actual Assessment Amount |
|----------------------|-------------------------------------|--------------------------------|--------------------------------|------------------------------------|
| 224                  | 179-280-36                          | 2.085                          | \$92.67                        | \$38.27                            |
| 252                  | 179-280-37                          | 2.377                          | \$105.64                       | \$43.63                            |
| 253                  | 179-280-38                          | 9.010                          | \$400.44                       | \$165.37                           |
| 104                  | 179-290-24                          | 3.051                          | \$135.60                       | \$56.00                            |
| 105                  | 179-290-25                          | 2.520                          | \$112.00                       | \$46.25                            |
| 106                  | 179-290-26                          | 9.750                          | \$433.33                       | \$178.95                           |
| 107                  | 179-290-27                          | 11.495                         | \$510.88                       | \$210.97                           |
| 137                  | 179-290-29                          | 4.720                          | \$209.77                       | \$86.63                            |
| 138                  | 179-290-30                          | 2.480                          | \$110.22                       | \$45.52                            |
| 219                  | 179-290-33                          | 2.830                          | \$125.78                       | \$51.94                            |
| 220                  | 179-290-34                          | 6.600                          | \$293.33                       | \$121.13                           |
| 227                  | 179-290-35                          | 5.590                          | \$248.44                       | \$102.60                           |
| 228                  | 179-290-36                          | 5.010                          | \$222.66                       | \$91.95                            |
| 260                  | 179-290-39                          | 4.020                          | \$178.66                       | \$73.78                            |
| 258                  | 179-290-40                          | 3.419                          | \$151.94                       | \$62.75                            |
| 259                  | 179-290-41                          | 8.299                          | \$368.83                       | \$152.32                           |
| 64                   | 179-300-04                          | 0.897                          | \$39.87                        | \$16.46                            |
| 65                   | 179-300-08                          | 0.797                          | \$35.42                        | \$14.63                            |
| 66                   | 179-300-10                          | 3.227                          | \$143.42                       | \$59.23                            |
| 67                   | 179-300-11                          | 1.986                          | \$88.27                        | \$36.45                            |
| 72                   | 179-340-08                          | 3.241                          | \$144.04                       | \$59.48                            |
| 250                  | 179-340-13                          | 21.180                         | \$941.32                       | \$388.73                           |
| 262                  | 179-340-14                          | 8.720                          | \$387.54                       | \$160.04                           |
| 263                  | 179-340-15                          | 0.781                          | \$34.70                        | \$14.33                            |
| 264                  | 179-340-16                          | 9.378                          | \$416.81                       | \$172.12                           |
| 161                  | 179-520-01                          | 0.000                          | \$0.00                         | \$0.00                             |
| 162                  | 179-520-02                          | 0.000                          | \$0.00                         | \$0.00                             |
| 163                  | 179-520-03                          | 0.000                          | \$0.00                         | \$0.00                             |
| 164                  | 179-520-04                          | 0.000                          | \$0.00                         | \$0.00                             |
| 165                  | 179-520-05                          | 0.000                          | \$0.00                         | \$0.00                             |
| 166                  | 179-520-06                          | 0.000                          | \$0.00                         | \$0.00                             |
| 167                  | 179-520-07                          | 0.000                          | \$0.00                         | \$0.00                             |
| 168                  | 179-520-08                          | 0.000                          | \$0.00                         | \$0.00                             |
| 169                  | 179-520-09                          | 0.000                          | \$0.00                         | \$0.00                             |
| 170                  | 179-520-10                          | 0.000                          | \$0.00                         | \$0.00                             |
| 171                  | 179-520-11                          | 0.000                          | \$0.00                         | \$0.00                             |
| 172                  | 179-520-12                          | 0.000                          | \$0.00                         | \$0.00                             |
| 173                  | 179-520-13                          | 0.000                          | \$0.00                         | \$0.00                             |
| 174                  | 179-520-14                          | 0.000                          | \$0.00                         | \$0.00                             |
| 175                  | 179-520-15                          | 0.000                          | \$0.00                         | \$0.00                             |
| 176                  | 179-520-16                          | 0.000                          | \$0.00                         | \$0.00                             |
| 177                  | 179-520-17                          | 0.000                          | \$0.00                         | \$0.00                             |
| 178                  | 179-520-18                          | 0.000                          | \$0.00                         | \$0.00                             |
| 179                  | 179-520-19                          | 0.000                          | \$0.00                         | \$0.00                             |
| 180                  | 179-520-20                          | 0.000                          | \$0.00                         | \$0.00                             |
| 181                  | 179-520-21                          | 0.000                          | \$0.00                         | \$0.00                             |
| 182                  | 179-520-22                          | 0.000                          | \$0.00                         | \$0.00                             |
| 183                  | 179-520-23                          | 0.000                          | \$0.00                         | \$0.00                             |

Stockton Airport Business Center  
Storm Drainage Basin Maintenance District

**SCHEDULE OF PARCELS, ADJUSTED DRAINAGE AREAS, ANNEXED AREAS &  
ASSESSMENT AMOUNTS FOR 2020-2021 BUDGET**

March 17, 2020

| Maintenance District                         | Assessor's Parcel Number (if known) | Adjusted Drainage Area (Acres) | 2020-2021 Maximum Assessment** | 2020-2021 Actual Assessment Amount |            |
|--|-------------------------------------|--------------------------------|--------------------------------|------------------------------------|------------|
|  | 184                                 | 179-520-24                     | 5.420                          | \$240.89                           | \$99.48    |
|  | 185                                 | 179-540-01                     | 0.270                          | \$12.00                            | \$4.96     |
|  | 186                                 | 179-540-02                     | 0.270                          | \$12.00                            | \$4.96     |
|  | 187                                 | 179-540-03                     | 0.270                          | \$12.00                            | \$4.96     |
|  | 188                                 | 179-540-04                     | 0.270                          | \$12.00                            | \$4.96     |
|  | 189                                 | 179-540-05                     | 0.270                          | \$12.00                            | \$4.96     |
|  | 190                                 | 179-540-06                     | 0.270                          | \$12.00                            | \$4.96     |
|  | 191                                 | 179-540-07                     | 0.270                          | \$12.00                            | \$4.96     |
|  | 192                                 | 179-540-08                     | 0.270                          | \$12.00                            | \$4.96     |
|  | 193                                 | 179-540-09                     | 0.270                          | \$12.00                            | \$4.96     |
|  | 194                                 | 179-540-10                     | 0.272                          | \$12.09                            | \$4.99     |
|  | 195                                 | 179-540-11                     | 0.272                          | \$12.09                            | \$4.99     |
|  | 196                                 | 179-540-12                     | 0.272                          | \$12.09                            | \$4.99     |
|  | 197                                 | 179-540-13                     | 0.270                          | \$12.00                            | \$4.96     |
|  | 198                                 | 179-540-14                     | 0.270                          | \$12.00                            | \$4.96     |
|  | 199                                 | 179-540-15                     | 0.270                          | \$12.00                            | \$4.96     |
|  | 200                                 | 179-540-16                     | 0.270                          | \$12.00                            | \$4.96     |
|  | 201                                 | 179-540-17                     | 0.270                          | \$12.00                            | \$4.96     |
|  | 202                                 | 179-540-18                     | 0.270                          | \$12.00                            | \$4.96     |
|  | 203                                 | 179-540-19                     | 0.270                          | \$12.00                            | \$4.96     |
|  | 204                                 | 179-540-20                     | 0.000                          | \$0.00                             | \$0.00     |
|  | 230                                 | 179-570-01                     | 1.095                          | \$48.67                            | \$20.10    |
|  | 231                                 | 179-570-02                     | 0.860                          | \$38.22                            | \$15.78    |
|  | 232                                 | 179-570-03                     | 0.889                          | \$39.51                            | \$16.32    |
|  | 233                                 | 179-570-04                     | 0.919                          | \$40.84                            | \$16.87    |
|  | 234                                 | 179-570-05                     | 0.969                          | \$43.07                            | \$17.78    |
|  | 235                                 | 179-570-06                     | 1.044                          | \$46.40                            | \$19.16    |
|  | 236                                 | 179-570-07                     | 0.787                          | \$34.98                            | \$14.44    |
|  | 237                                 | 179-570-08                     | 0.787                          | \$34.98                            | \$14.44    |
|  | 238                                 | 179-570-09                     | 1.400                          | \$62.22                            | \$25.70    |
|  | 239                                 | 179-570-10                     | 1.085                          | \$48.22                            | \$19.91    |
|  | 240                                 | 179-570-11                     | 0.818                          | \$36.36                            | \$15.01    |
|  | 241                                 | 179-570-12                     | 0.818                          | \$36.36                            | \$15.01    |
|  | 242                                 | 179-570-13                     | 1.273                          | \$56.58                            | \$23.36    |
| <b>subtotal original district assessment</b> |                                     | <b>420.26</b>                  | <b>\$18,678.23</b>             | <b>\$7,713.37</b>                  |            |
|  |                                     |                                |                                |                                    |            |
|  | 146                                 | 177-140-24*                    | 0.225                          | \$16.95                            | \$4.13     |
|  | 148                                 | 177-140-26                     | 24.740                         | \$1,863.66                         | \$454.07   |
|  | 206                                 | 177-140-32                     | 24.000                         | \$1,807.92                         | \$440.49   |
|  | 211                                 | 177-140-33                     | 55.190                         | \$4,157.46                         | \$1,012.93 |
|  | 209                                 | 177-140-34                     | 0.000                          | \$0.00                             | \$0.00     |
|  | 210                                 | 177-140-35                     | 0.000                          | \$0.00                             | \$0.00     |
|  | 150                                 | 177-140-36                     | 30.030                         | \$2,262.16                         | \$551.16   |
|  | 261                                 | 177-140-39                     | 70.750                         | \$5,329.60                         | \$1,298.52 |
|  | 113                                 | 177-290-01                     | 11.92                          | \$897.93                           | \$218.77   |
|  | 114                                 | 177-290-05                     | 15.55                          | \$1,171.38                         | \$285.40   |
|  | 133                                 | 177-320-02                     | 3.84                           | \$289.27                           | \$70.48    |
|  | 130                                 | 177-320-07                     | 3.41                           | \$256.88                           | \$62.59    |

Stockton Airport Business Center  
Storm Drainage Basin Maintenance District

**SCHEDULE OF PARCELS, ADJUSTED DRAINAGE AREAS, ANNEXED AREAS &  
ASSESSMENT AMOUNTS FOR 2020-2021 BUDGET**

March 17, 2020

| Maintenance District                       | Assessor's Parcel Number (if known) | Adjusted Drainage Area (Acres) | 2020-2021 Maximum Assessment** | 2020-2021 Actual Assessment Amount |          |
|--|-------------------------------------|--------------------------------|--------------------------------|------------------------------------|----------|
|  | 143                                 | 177-320-08                     | 2.850                          | \$214.69                           | \$52.31  |
|  | 144                                 | 177-320-09                     | 4.060                          | \$305.84                           | \$74.52  |
|  | 153                                 | 177-320-11                     | 6.440                          | \$485.13                           | \$118.20 |
|  | 154                                 | 177-320-12                     | 4.100                          | \$308.85                           | \$75.25  |
|  | 117                                 | 177-330-02                     | 2.07                           | \$155.93                           | \$37.99  |
|  | 118                                 | 177-330-03                     | 2.04                           | \$153.67                           | \$37.44  |
|  | 119                                 | 177-330-04                     | 1.98                           | \$149.15                           | \$36.34  |
|  | 120                                 | 177-330-05                     | 1.99                           | \$149.91                           | \$36.52  |
|  | 121                                 | 177-330-06                     | 1.98                           | \$149.15                           | \$36.34  |
|  | 122                                 | 177-330-07                     | 0.00                           | \$0.00                             | \$0.00   |
|  | 126                                 | 177-330-13                     | 1.22                           | \$91.90                            | \$22.39  |
|  | 127                                 | 177-330-14                     | 1.21                           | \$91.15                            | \$22.21  |
|  | 128                                 | 177-330-15                     | 1.34                           | \$100.94                           | \$24.59  |
|  | 123                                 | 177-330-20                     | 9.51                           | \$716.39                           | \$174.54 |
|  | 124                                 | 177-330-21                     | 1.42                           | \$106.97                           | \$26.06  |
|  | 125                                 | 177-330-22                     | 1.41                           | \$106.22                           | \$25.88  |
|  | 155                                 | 177-330-24                     | 2.750                          | \$207.16                           | \$50.47  |
|  | 156                                 | 177-330-25                     | 2.270                          | \$171.00                           | \$41.66  |
|  | 160                                 | 177-330-27                     | 5.000                          | \$376.65                           | \$91.77  |
|  | 216                                 | 177-330-28                     | 2.630                          | \$198.12                           | \$48.27  |
|  | 217                                 | 177-330-29                     | 2.580                          | \$194.35                           | \$47.35  |
| <b>subtotal Parkside/Massie annexation</b> |                                     | <b>298.51</b>                  | <b>\$22,486.39</b>             | <b>\$5,478.63</b>                  |          |
| <b>DISTRICT TOTALS</b>                     |                                     | <b>718.770</b>                 | <b>\$41,164.62</b>             | <b>\$13,192.00</b>                 |          |

AMENDMENT NO. 10  
 AMENDED ASSESSMENT DIAGRAM  
 STOCKTON AIRPORT BUSINESS PARK ASSESSMENT  
 DISTRICT, PROJECT NO. 84-1  
 STORM BASIN MAINTENANCE DISTRICT,  
 CITY OF STOCKTON, SAN JOAQUIN COUNTY,  
 CALIFORNIA

STOCKTON, CALIFORNIA

MARCH, 2020

SCALE: 1"=500'

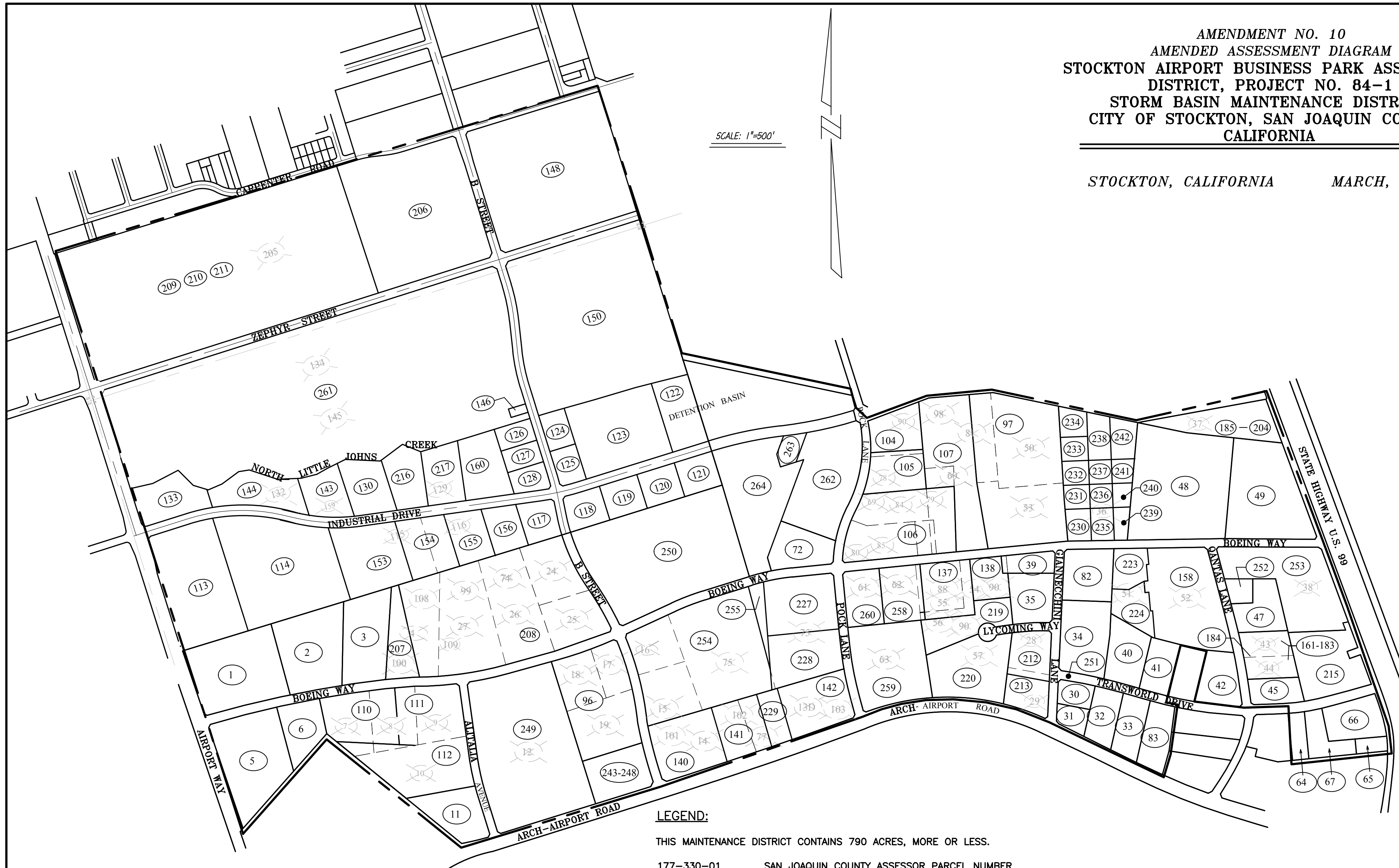

THIS AMENDMENT NO. 10 AMENDS THE AMENDED ASSESSMENT DIAGRAM FOR THE STOCKTON AIRPORT BUSINESS PARK ASSESSMENT DISTRICT, PROJECT NO. 84-1, STORM BASIN MAINTENANCE DISTRICT, CITY OF STOCKTON, COUNTY OF SAN JOAQUIN, CALIFORNIA, PREVIOUSLY RECORDED IN BOOK 2, PAGE 85 OF MAPS OF ASSESSMENTS AND COMMUNITY FACILITIES DISTRICTS, IN THE OFFICE OF THE RECORDER OF SAN JOAQUIN COUNTY, STATE OF CALIFORNIA.

LEGEND:

THIS MAINTENANCE DISTRICT CONTAINS 790 ACRES, MORE OR LESS.

177-330-01 SAN JOAQUIN COUNTY ASSESSOR PARCEL NUMBER

(73) MAINTENANCE DISTRICT DIAGRAM NUMBER

(X3) FORMER DISTRICT DIAGRAM NUMBER

--- FORMER LOT LINE

— CURRENT LOT LINE

--- AMENDED ASSESSMENT DISTRICT BOUNDARY



**SIEGFRIED**

3428 Brookside Road, Stockton, California 95219  
 209-943-2021 www.siegfriedeng.com Fx: 209-942-0214

- CIVIL ENGINEERING
- STRUCTURAL ENGINEERING
- SURVEYING
- PLANNING